

### OPERATING THE NIO-P

1. Remove the NIO-P from its packaging. Locate and disinfect access site. Ensure penetration depth indicator correlates with patient's age. For 3-9 year olds, leave the red spacer intact. For 9-12 year olds, remove the red spacer.

Age	Proximal Tibia
3-9 years	14mm
9-12 years	Adjust to 18mm

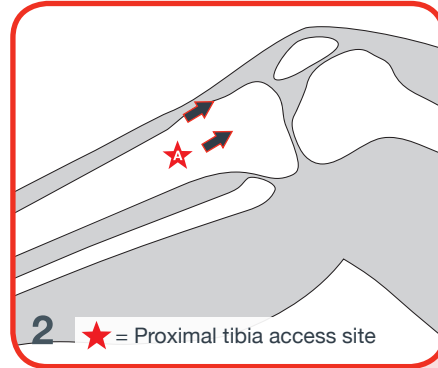

### LOCATING THE PROXIMAL TIBIA

2. This device features locating arrows which aid in access site landmarking.

**A.** To operate, place the designated locating arrow (R for right leg, L for left leg) on the prominent aspect of the tibial tuberosity, aligned parallel to the long axis of the tibia. Locating arrows should be pointing up towards the patient's knee.

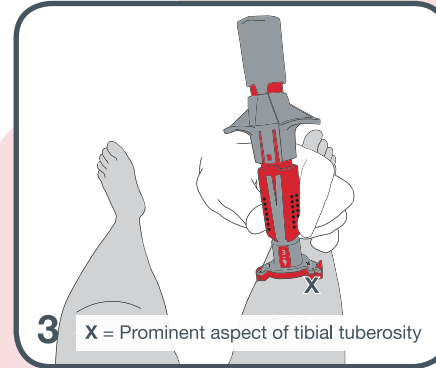

3. With your non-dominant hand, hold the NIO-P by the textured dots at a 90° angle to the access site and maintain downward pressure.



4. With the device in contact with the patient's skin, unlock the NIO-P by rotating the cap 90° in either direction until the cap aligns with the trigger wings. **Deploying the NIO-P is always a two-handed procedure.**

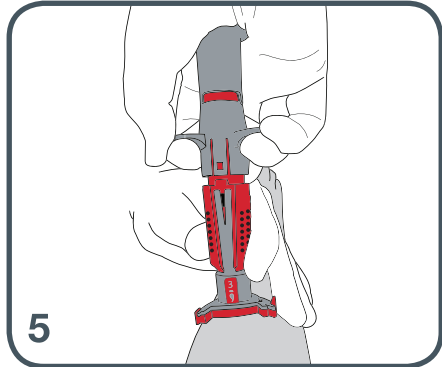

5. Place the palm of your dominant hand over the cap of the NIO-P and apply downward pressure. With your non-dominant hand, continue to stabilize the NIO-P against the patient's skin. While maintaining downward pressure with your dominant hand, use your fingers to squeeze the trigger wings. This will deploy the device.

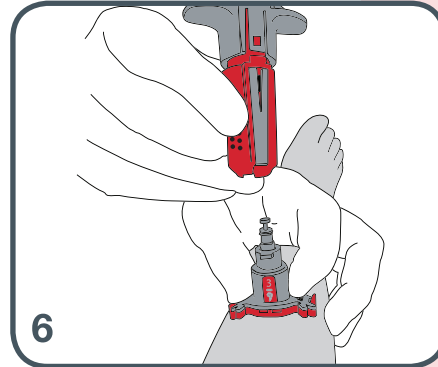

6. Grasp and hold the red stabilizer base with your fingers and gently lift the NIO-P in an upward and rotating motion.

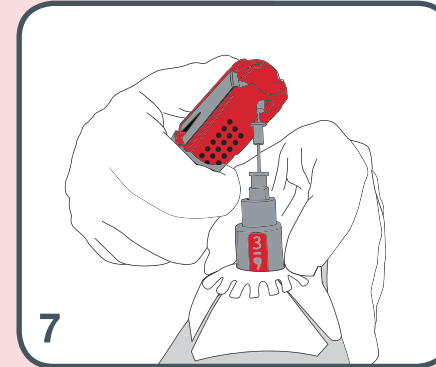

7. Apply the NIO Fixation dressing over the stabilizer base. Next, hold the stabilizer base firmly and remove the trocar by pulling it up with your fingers or by using the keyhole notch on the distal end of the device, leaving the cannula in the stabilizer base.

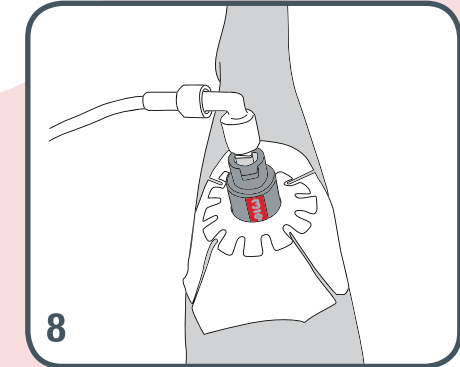

8. Connect a syringe and aspirate for bone marrow. Confirm placement by flushing with fluid per institutional protocol. To apply extension tubing with primed tubing, press luer hub down firmly and apply a quarter turn clockwise.