

DETERGENT WIPES

Ideal for multi-surface cleaning and damp dusting, Medipal Detergent Wipes have an innovative low-smear formula to provide effective cleaning with no visible residue. Alcohol free and easy-to-use. 2 products in this range.



AT A GLANCE:

- ✓ Alcohol Free
- ✓ Neutral pH
- ✓ Low smear formula
- ✓ No visible residue

IDEAL FOR:

- ✓ Cleaning and damp dusting non porous surfaces
- ✓ Cleaning patient shared equipment where there is a low risk of infection
- ✓ Removing soiling from surfaces before disinfection



SKIN HYGIENE



HIGH LEVEL DISINFECTION



SURFACE CLEANING



SURFACE DISINFECTANT



Scan for online factsheet
and safety data sheet

HOW TO USE:

STEP 1

RISK ASSESSMENT

Please follow your agreed risk assessment policy guidelines regarding the use of PPE.

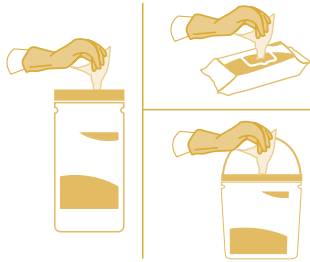
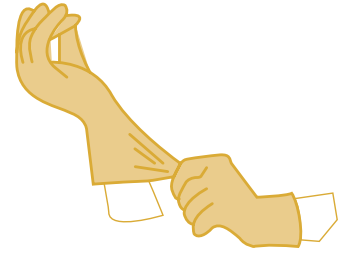

STEP 2

WIPE SELECTION

Choose the dispenser type and dispense the wipe.

STEP 3

S-SHAPE TECHNIQUE

Wipe the surface in an S Shape moving from clean to dirty. Use the wipe flat not scrunched.

Do not go over the same area twice with the same wipe.

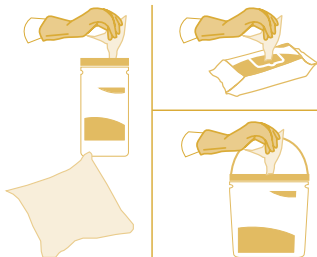
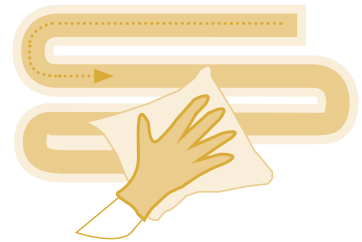

STEP 4

FRESH WIPE

Use a fresh wipe if your wipe becomes soiled or dry.

STEP 5

DISCARD

Discard used wipes in the appropriate waste bin following your local agreed guidelines.

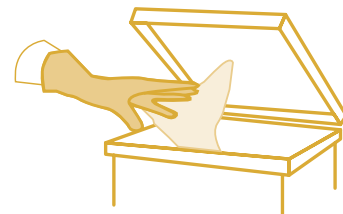

Do not flush



STEP 6

LET DRY

Allow the surface to dry before use.

TECHNICAL DETAILS

”

Medipal's proprietary Tritex[®] material is made by bonding layers of spunbond and meltblown polypropylene fibres together in a high heat process. The addition of a hydrophilic coating means optimum and consistent liquid discharge.

CHEMICAL FORMULATION

Medipal Detergent cleaning solution is formulated using environmentally friendly and VOC free ingredients. The specially designed formula contains surfactants and a naturally derived ingredient which removes contamination from surfaces leaving them clean and streak free. The formulation is maintained at a skin balanced pH and is dermatologically tested to ensure skin safety for frequent users.

MATERIALS

Tritex[®] material is made by bonding layers of spunbond and meltblown polypropylene fibres together in a high heat process before a hydrophilic coating is applied. This material is 100% synthetic.



High Strength

The material offers high strength in both directions – across and along the wipe.



Excellent Solution Retention

Ensuring even wetness throughout the wipe.



Very Low Linting

Low risk of leaving contaminating fibres on surfaces.



Efficient Solution Release

Active wipe ingredients are transferred to the surface rather than being trapped in the wipe material fibres.

PRODUCTS WITHIN THIS RANGE

100 WIPE FLOW WRAP



Quantity:
100 per pack
12 packs per case

Product Code:
S532110MP

350 WIPE BUCKET



Quantity:
350 per pack
4 packs per case

Product Code:
W535110MP