



EN

3M™ Aura™ Particulate Respirator

CN

3M™ AurC™ 粒狀物防護口罩

MY

3M™ Aura™ Respirator Partikulat

AU (NZ)

3M™ Aura™ Particulate Respirator



www.3m.com/OccSafety

EN

These products meet the requirements of EN149:2001+A1:2009, filtering facepiece respirators for use against particles. They should be used to protect the wearer from solid and non-volatile liquid particles only.

⚠ Particular attention should be given to warning statements where indicated.

⚠ WARNINGS AND LIMITATIONS

Always be sure that the complete product is:

- Suitable for the application;
- Fitted correctly;
- Worn during all periods of exposure;
- Replaced when necessary.

• Proper selection, training, use and appropriate maintenance are essential in order for the product to help protect the wearer from certain airborne contaminants. Failure to follow all instructions on the use of these respiratory protection products and/or failure to properly wear the complete product during all periods of exposure may adversely affect the wearer's health, lead to severe or life threatening illness or permanent disability.

• For suitability and proper use follow local regulations and refer to all information supplied. For more information contact a safety professional/3M representative.

• Before use, the wearer must be trained in use of the complete product in accordance with applicable Health and Safety standards/guidance.

• These products do not contain components made from natural

rubber latex.

- These products do not protect against gases/vapours.
- Do not use in atmospheres containing less than 19.5% oxygen. (3M definition. Individual countries may apply their own limits on oxygen deficiency. Seek advice if in doubt).
- Do not use for respiratory protection against atmospheric contaminants/concentrations which are unknown or immediately dangerous to life and health (IDLH).
- Do not use with beards or other facial hair that may inhibit contact between the face and the product thus preventing a good seal.

- Leave the contaminated area immediately if:
 - a) Breathing becomes difficult.
 - b) Dizziness or other distress occurs.
- Discard and replace the respirator if it becomes damaged, breathing resistance becomes excessive or at the end of the shift.
- Dispose in accordance with local regulations
- Do not alter, modify, clean or repair this respirator.
- In case of intended use in explosive atmospheres, contact 3M.
- Before initial use, always check that the product is within the stated shelf life (use by date).

FITTING INSTRUCTIONS

See Figure 1.

Before fitting device, ensure hands are clean.

All respirator components should be inspected for damage prior to each use.

1. With reverse side up and using tab, separate top and bottom panels

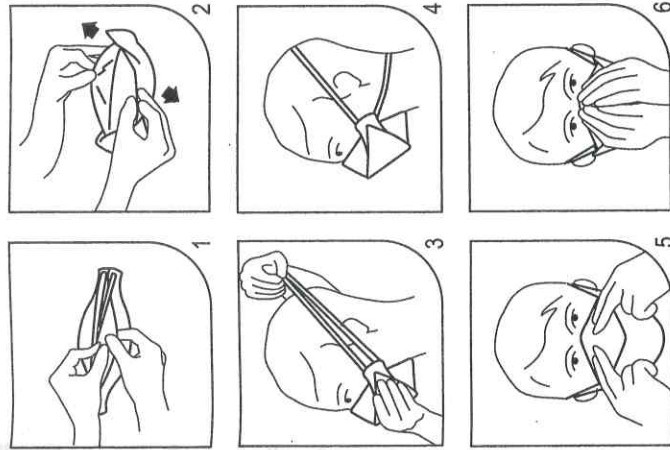

Figure 1. 圖 1.

to form a cup shape.

1. Bend slightly at the centre of the noseclip.
2. Ensure both panels are fully unfolded.
3. Cup respirator in one hand with open side towards face. Take both straps in other hand. Hold respirator under chin, with nosepiece up, and pull straps over head.
4. Locate the upper strap across the crown of the head and the lower strap below the ears. Straps must not be twisted. Adjust top and bottom panels for a comfortable fit, ensuring panels and tab are not folded in.
5. Using both hands, mould noseclip to the shape of the nose to ensure a close fit and good seal. Pinching the noseclip using only one hand may result in less effective respirator performance.
6. The seal of the respirator on the face should be fit-checked before entering the workplace.

FIT CHECK

1. Cover the front of the respirator with both hands being careful not to disturb the fit of the respirator.
 - 2a) UNVALVED respirator - EXHALE sharply;
 - 2b) VALVED respirator - INHALE sharply.
 3. If air leaks around the nose, re-adjust the noseclip to eliminate leakage. Repeat the above fit check.
 4. If air leaks at the respirator edges, work the straps back along the sides of the head to eliminate leakage. Repeat the above fit check.
- If you CANNOT achieve a proper fit DO NOT enter the hazardous area.**

See your supervisor.

Users should be fit tested in accordance with national requirements.

美商3M台灣子公司個人安
全產品部門
台北市新化南路2段95號6樓
電話: (02) 2704-9011

3M Malaysia
Sdn. Bhd. (7251 V), Bangunan 3M
47410 Petaling Jaya, Selangor, Malaysia.
603 - 7606 2888

3M Australia Pty Limited
1 Rivett Road, North Ryde
N.S.W. 2113
+61 (1)800 024 464

3M New Zealand Limited
94 Apollo Drive, Rosedale
AUCKLAND 0632, New Zealand
+64 (0)800 384 357

3M Technologies Pte. Ltd.
10 Ang Mo Kio Street 65, Singapore 569659
Tel: +65 6450 8888
Emergency Tel: +65 6591 6888 (8:15am - 5pm)

3M 香港有限公司
香港屈臣道15號
維多利亞中心5字樓
(852) 28066111

3M United Kingdom PLC, Cain Road, Bracknell, Berkshire,
RG12 8HT, UK
3M Wroclaw Sp.z o.o, Kowalska 143, 51-424 Wroclaw, Poland

For information regarding fit testing procedures, please contact 3M.

STORAGE AND TRANSPORTATION

Store in accordance with manufacturer's instructions, see packaging.

NOTE

Average conditions may exceed 25°C / 80% RH for limited periods. They can reach an average of 38°C / 85% RH, provided that this is for no more than 3 months in the shelf life of the product.

When storing or transporting this product use original packaging provided.

Do not store in direct sunlight.

MARKING

NR = Non reusable (single shift use only)

D = Meets the clogging requirements

⌚ End of Shelf Life

↕ Temperature Range

↕ Maximum Relative Humidity

APPROVALS

These products are type approved and audited annually by either: BSI Group, The Netherlands B.V. Say Building, John M. Keynesplein 9, 1066 EP Amsterdam, The Netherlands, Notified Body No. 2797 and / or BSI Assurance UK Ltd, Kitemark Court, Davy Avenue, Knowlhill, Milton Keynes MK5 8PP, UK, Notified Body No. 0086. These products meet the requirements of European Regulation (EU) 2016/425 and applicable local legislation. The applicable European/local legislation and Notified Body can be determined by reviewing the Certificate(s) and Declaration(s) of Conformity at www.3m.com/Respiratory/certs.